

Class I, Div. 2,
Groups A,B,C,D⁽¹⁾
Class I, Zone 1&2, AEXe II
NEMA 4X, IP66

TMC Connectors For Jacketed Metal Clad Cable

Applications

- TMC connectors are designed for use with the following cables: MC/MCHL – Corrugated Interlocked Aluminium/Steel Armor and Continuously Welded Armor Cables, e.g. TECK or CLX.
- TMC connectors provide a means for terminating jacketed type MC cable, forming a mechanical watertight connection and providing ground continuity for cable armor.
- For Class I hazardous locations – See TMCX.
- Watertight-NEMA Type 4.

Features

- Integral 'O' ring face seal providing – 4X & IP66
- Independent sealing and armor clamping
- True 360° grounding
- Superior pull out prevention
- Compact slim profile
- Reduced installation time (no disassembly required)
- Widest Cable acceptance Range
- Re-usable design

- Additional Integral Deluge proof seal for protection in extreme offshore and onshore environments
- Metric option available

Standard Materials

- Bodies, Sleeve and gland nut are copper-free aluminum, nickel plated brass, stainless steel.
- Grounding spring is stainless steel.
- Bushing is LSF-TPE (halogen-free).
- Stop and slip washers are nylon.
- O-ring is Viton.

Size Ranges

- Trade sizes 1/2" thru 4".
- Cable Jacket Diameter Range: 0.354" thru 4.220".
- Cable Armor Diameter Range: 0.342" thru 4.020".

Compliances

- UL Standard 514B, 886
- CSA Standard C22.2 No 18, 174
- IEC60079
- UL Listing File: E163112
- CSA Certificate No: 1129339
- NEMA 3, 4 & 4X and IP66

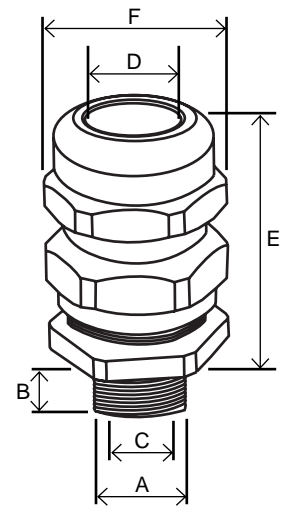

(1) Where explosion proof enclosures are being used the TMC must be installed in conjunction with an approved pouring or compound sealing fitting. In Division 2 areas the TMC can be fitted directly to an enclosure which has no source of ignition in accordance with NEC/CEC requirements.

Order Reference			Entry Thread 'A'	Min Thread Length 'B'	Cable Armor Diameter 'C'				Cable Jacket Diameter 'D'		Nominal Assembly Length 'E'	Envelope Diameter 'F'
Aluminum	NP Brass	Stainless Steel			End Stop in		End Stop out		Min	Max		
TMC050SA	TMC050SNB	TMC050SSS	1/2"	0.59	-	-	0.342	0.503	0.354	0.547	2.20	1.31
TMC050A	TMC050NB	TMC050SS	1/2"	0.59	-	-	0.510	0.669	0.550	0.787	2.20	1.57
TMC050LA TMC075A	- TMC075NB	- TMC075SS	1/2" 3/4"	0.59 0.59	0.591	0.756	0.756	0.917	0.669	1.035	2.20	1.79
TMC075LA TMC100A	- TMC100NB	- TMC100SS	3/4" 1"	0.63 0.63	0.825	0.969	0.969	1.150	0.910	1.268	2.24	2.18
TMC100LA TMC125A	- TMC125NB	- TMC125SS	1" 1-1/4"	0.63 0.63	1.083	1.228	1.228	1.386	1.161	1.504	2.24	2.40
TMC125LA TMC150A	- TMC150NB	- TMC150SS	1-1/4" 1-1/2"	0.63 0.63	1.320	1.461	1.461	1.618	1.402	1.736	2.37	2.62
TMC150LA TMC200SA	- TMC200SNB	- TMC200SSS	1-1/2" 2"	0.63 0.63	1.508	1.677	1.677	1.854	1.579	2.008	2.58	3.06
TMC150XLA TMC200A	- TMC200NB	- TMC200SS	1-1/2" 2"	0.63 0.63	1.772	1.933	1.933	2.087	1.858	2.205	2.49	3.28
TMC200LA TMC250SA	- TMC250SNB	- TMC250SSS	2" 2-1/2"	0.90 0.90	2.052	2.161	2.161	2.320	2.079	2.441	2.50	3.49
TMC200XLA TMC250A	- TMC250NB	- TMC250SS	2" 2-1/2"	0.90 0.90	2.247	2.406	2.406	2.545	2.327	2.677	2.52	3.71
TMC300A	TMC300NB	TMC300SS	3"	0.98	2.543	2.776	2.776	2.965	2.622	3.126	3.57	4.80
TMC350A	TMC350NB	TMC350SS	3-1/2"	1.437	2.913	3.291	3.291	3.485	2.992	3.827	4.61	5.82
TMC400A	TMC400NB	TMC400SS	4"	1.437	-	-	3.500	4.020	3.700	4.220	7.66	5.84

Class I, Div. 1 and 2, Groups A,B,C,D
 Class I, Zone 1, AExd IIC
 Class II, Div. 1 and 2
 Groups E,F,G
 Class III
 NEMA 4X, IP66

TMCX Connectors For Jacketed Metal Clad Cable: Explosionproof, Dust-Ignitionproof

TMCX For Hazardous Locations

Applications

- TMCX connectors are designed for use with the following cables: MC/MCHL – Corrugated/ Interlocked Aluminium/Steel Armor and Continuously Welded Armor Cables, e.g. TECK or CLX
- TMCX connectors provide a means for terminating jacketed type MC cable, forming a mechanical watertight connection and providing ground continuity for cable armor.
- For use on horizontal or vertical runs.
- For use in Class I, Div. 1 & 2 and Class II, Div. 1 & 2 hazardous locations.
- For non-hazardous locations – Use TMC.

Features

- Independent sealing and armor clamping
- True 360° grounding
- Superior pull out prevention
- Compact slim profile
- Reduced installation time
- Widest cable acceptance range
- Supplied complete with epoxy sealing compound

- Disconnectable design
- Additional Integral Deluge proof seal for protection in extreme offshore and onshore environments

Standard Materials

- Bodies, Sleeve and gland nut are copper-free aluminum, nickel plated brass, stainless steel.
- Grounding spring is stainless steel.
- Bushing is LSF-TPE (halogen-free).
- Stop and slip washers are nylon.
- O-ring is Viton.

Size Ranges

- Trade sizes 1/2" thru 4".
- Cable Jacket Diameter Range: 0.345" thru 4.220".
- Cable Armor Diameter Range: 0.342" thru 4.020".

Compliances

- UL Standard 514B, 886, 2225, 2279
- CSA Standard C22.2 No 18, 174 & IEC 60079
- UL Listing File: E161256
- CSA Certificate No: 1129339
- NEMA 3, 4, 4X & IP66

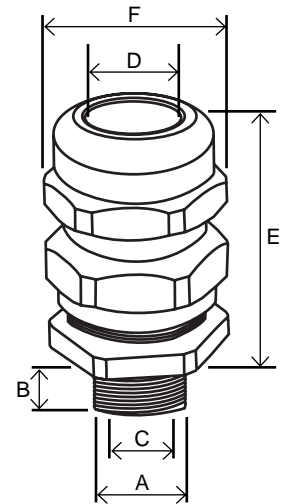

Order Reference			Entry Thread 'A'		Min Thread Length 'B'	Cable Armor Diameter 'C'				Cable Jacket Diameter 'D'		Nominal Assembly Length 'E'	Envelope Diameter 'F'	Compound Weight in OZ's
						End Stop in		End Stop out						
Aluminum	NP Brass	Stainless Steel	NPT	Metric		Min	Max	Min	Max	Min	Max			
TMCX050SA	TMCX050SNB	TMCX050SSS	1/2"	M20	0.59	-	-	0.342	0.503	0.354	0.547	2.20	1.31	1/2
TMCX050A	TMCX050NB	TMCX050SS	1/2"	M20	0.59	-	-	0.510	0.669	0.550	0.787	2.20	1.57	1/2
TMCX075A	TMCX075NB	TMCX075SS	3/4"	M25	0.59	0.591	0.756	0.756	0.917	0.669	1.035	2.20	1.79	1/2
TMCX100A	TMCX100NB	TMCX100SS	1"	M32	0.63	0.825	0.969	0.969	1.150	0.910	1.268	2.24	2.18	1-1/4
TMCX125A	TMCX125NB	TMCX125SS	1-1/4"	M40	0.63	1.083	1.228	1.228	1.386	1.161	1.504	2.24	2.40	1-1/4
TMCX150A	TMCX150NB	TMCX150SS	1-1/2"	M50	0.63	1.320	1.461	1.461	1.618	1.402	1.736	2.37	2.62	2
TMCX200SA	TMCX200SNB	TMCX200SSS	2"	M50	0.63	1.508	1.677	1.677	1.854	1.579	2.008	2.60	3.06	3
TMCX200A	TMCX200NB	TMCX200SS	2"	M63	0.63	1.772	1.933	1.933	2.087	1.858	2.205	2.81	3.28	4-3/4
TMCX250SA	TMCX250SNB	TMCX250SSS	2-1/2"	M63	0.90	2.052	2.161	2.161	2.320	2.079	2.441	2.88	3.49	9-1/2
TMCX250A	TMCX250NB	TMCX250SS	2-1/2"	M75	0.90	2.247	2.406	2.406	2.545	2.327	2.677	2.88	3.71	9-1/2
TMCX300A	TMCX300NB	TMCX300SS	3"	M90	0.98	2.543	2.776	2.776	2.965	2.622	3.126	3.92	4.80	12-1/2
TMCX350A	TMCX350NB	TMCX350SS	3-1/2"	M100	1.437	2.913	3.291	3.291	3.485	2.992	3.827	4.61	5.82	19
TMCX400A	TMCX400NB	TMCX400SS	4"	M110	1.437	-	-	3.500	4.020	3.700	4.220	7.66	5.84	19